

State of Colorado
Oil and Gas Conservation Commission

1120 Lincoln Street, Suite 801, Denver, Colorado 80203
Phone: (303) 894-2100 Fax: (303) 894-2109



Document Number:

401086328

Date Received:

[Empty box for Date Received]

Spill report taken by:

Spill/Release Point ID:

SPILL/RELEASE REPORT (INITIAL)

This form is to be submitted by the party responsible for the oil and gas spill or release. Any spill or release which may impact waters of the State must be reported as soon as practicable; any spill over 20 bbls must be reported within 24 hours and all spills over five bbls must be reported within ten days. Submit a Site Investigation and Remediation Workplan (Form 27) when requested by the Director.

OPERATOR INFORMATION

Name of Operator: <u>8 NORTH LLC</u>	Operator No: <u>10575</u>	Phone Numbers
Address: <u>370 17TH STREET SUITE 5300</u>		Phone: <u>(720) 481-2372</u>
City: <u>DENVER</u> State: <u>CO</u> Zip: <u>80202</u>		Mobile: <u>(720) 481232</u>
Contact Person: <u>Josh Carlisle</u>		Email: <u>jcarlisle@extractionog.com</u>

INITIAL SPILL/RELEASE REPORT

Initial Spill/Release Report Doc# 401086328

Initial Report Date: 07/29/2016 Date of Discovery: 07/29/2016 Spill Type: Historical Release

Spill/Release Point Location:

Location of Spill/Release: QTRQTR NWSW SEC 15 TWP 1N RNG 69W MERIDIAN 6

Latitude: 40.048300 Longitude: -105.100450

Municipality (if within municipal boundaries): Erie County: BOULDER

Reference Location:

Facility Type: TANK BATTERY Facility/Location ID No 321264
 No Existing Facility or Location ID No.
 Well API No. (Only if the reference facility is well) 05- -

Fluid(s) Spilled/Released (please answer Yes/No):

Was one (1) barrel or more spilled outside of berms or secondary containment? Yes

Secondary containment, including walls & floor regardless of construction material, must be sufficiently impervious to contain any discharge from primary containment until cleanup occurs.

Were Five (5) barrels or more spilled? No

Estimated Total Spill Volume: use same ranges as others for values

Estimated Oil Spill Volume(bbl): <u>Unknown</u>	Estimated Condensate Spill Volume(bbl): <u>0</u>
Estimated Flow Back Fluid Spill Volume(bbl): <u>0</u>	Estimated Produced Water Spill Volume(bbl): <u>0</u>
Estimated Other E&P Waste Spill Volume(bbl): <u>0</u>	Estimated Drilling Fluid Spill Volume(bbl): <u>0</u>

Specify: _____

Land Use:

Current Land Use: CROP LAND Other(Specify): _____

Weather Condition: Sunny

Surface Owner: OTHER (SPECIFY) Other(Specify): Boulder County Open Space

Check if impacted or threatened by spill/Release (please answer Yes/No to all that apply):

Waters of the State Residence/Occupied Structure Livestock Public Byway Surface Water Supply Area
 As defined in COGCC 100-Series Rules

Describe what is known about the spill/release event (what happened -- including how it was stopped, contained, and recovered):

During pressure testing a dump line leak was discovered at the Leyner 61N69W15NWSE location. Excavation and repair activities commenced and hydrocarbon impacted soil was encountered in the excavation. Groundwater was not encountered in the excavation. Soil samples were collected from the excavation area and submitted for laboratory analysis of benzene, toluene, ethylbenzene and total xylenes (BTEX) by USEPA Method 8260 and total petroleum hydrocarbons (TPH) by USEPA Method 8015. Site assessment activities are ongoing at this location.

List Agencies and Other Parties Notified:

OTHER NOTIFICATIONS

<u>Date</u>	<u>Agency/Party</u>	<u>Contact</u>	<u>Phone</u>	<u>Response</u>
7/29/2016	Boulder County Open Space	Mindy Carson Hatcher	-- email	
7/29/2016	City of Erie	Marty Ostholthoff	-- email	

OPERATOR COMMENTS:

--

I hereby certify all statements made in this form are to the best of my knowledge true, correct, and complete.

Signed: _____ Print Name: Josh Carlisle

Title: Environmental Supervisor Date: _____ Email: jcarlisle@extractionog.com

COA Type

Description

--	--

Attachment Check List

Att Doc Num

Name

401086376	TOPOGRAPHIC MAP
-----------	-----------------

Total Attach: 1 Files

General Comments

User Group

Comment

Comment Date

--	--	--

Total: 0 comment(s)

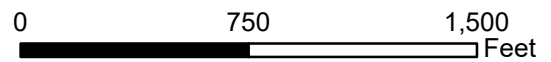
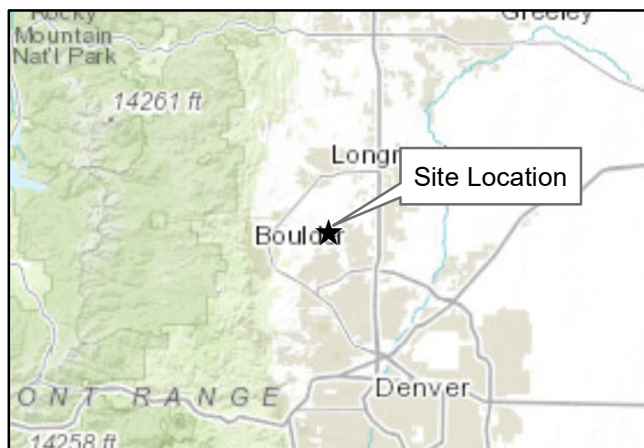
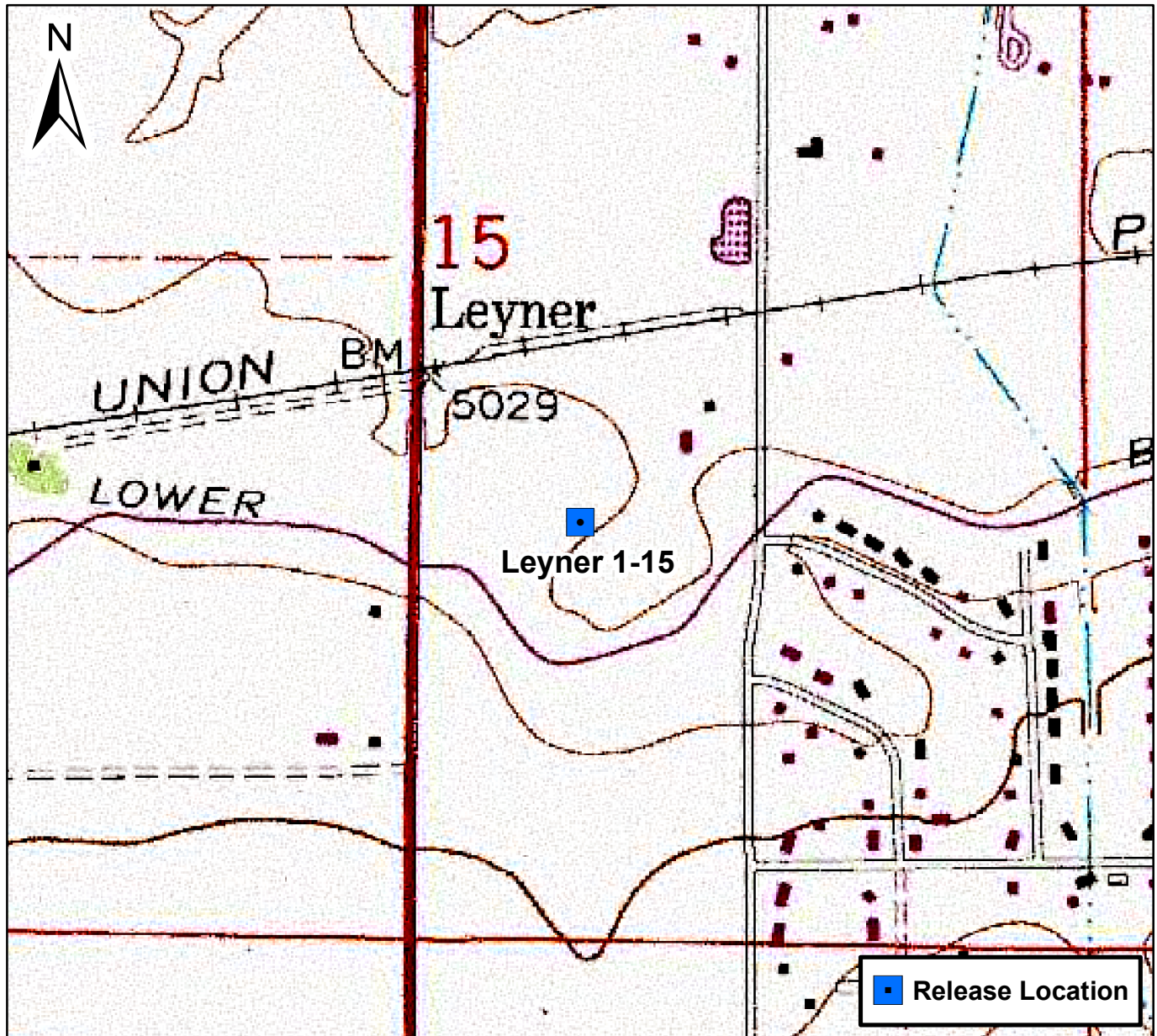

Figure 1

Site Location Map
 Leyner 1-15
 NWSE S15 T1N R69W
 Boulder County, Colorado

